

MARSHALL COUNTY, W. VA.
UNION DISTRICT

BENWOOD JUNCTION, W. VA.
5156+67 E. Station

CITY OF BENWOOD W. VA.


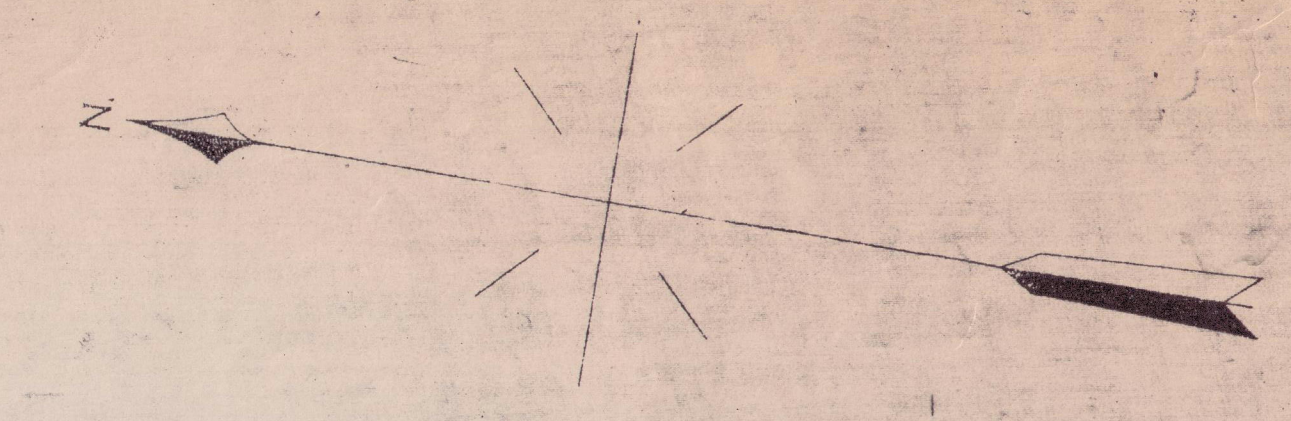

NO.	REVISION	REFERENCE	DATE	AGE	BY
1	Active Switching Sheet	Map No. DE 3373	4-14-83	571.78	TUM
2	State of Land in Monongahela Properties, Inc.	Map No. DE 4033	10-3-83	-	W.A.M.
3	Traced Heavy Rd. to VA. 2011	DE 3283	12-28-83	589.74	D.L.H.
4	Remove 200 ft. Ret. in Place - 1785 TP	DE 3355	4-22-84	593.81	W.A.M.
5	Remove 100 ft. Ret. in Place - 1785 TP	DE 3355	4-22-84	593.81	W.A.M.
6	Remove 100 ft. Ret. in Place - 1785 TP	DE 3355	4-22-84	593.81	W.A.M.
7	Remove 100 ft. Ret. in Place - 1785 TP	DE 3355	4-22-84	593.81	W.A.M.
8	Remove 100 ft. Ret. in Place - 1785 TP	DE 3355	4-22-84	593.81	W.A.M.
9	Remove 100 ft. Ret. in Place - 1785 TP	DE 3355	4-22-84	593.81	W.A.M.
10	Remove 100 ft. Ret. in Place - 1785 TP	DE 3355	4-22-84	593.81	W.A.M.

FOR SCHEDULE OF CHANGES AFTER DATE
OF VALUATION SEE SHEET NO. 36 a

FOR LAND SCHEDULE SEE SHEET NO. 35

STATION MAP
THE BALTIMORE AND OHIO RAILROAD COMPANY
OPERATED BY
THE BALTIMORE AND OHIO RAILROAD COMPANY
MONONGAH DIVISION MAIN LINE
STATION 5153+50 TO STATION 5167+00
SCALE: 1 IN = 100 FT. JUNE 30, 1918
OFFICE OF VALUATION ENGINEER
BALTIMORE, MD.

V-45.2
5-36

Sheet No. 536 of 38 primary and supplemental sheet