

BELMONT COUNTY, OHIO
MEAD TOWNSHIP
T. 5 N. R. 3 W.

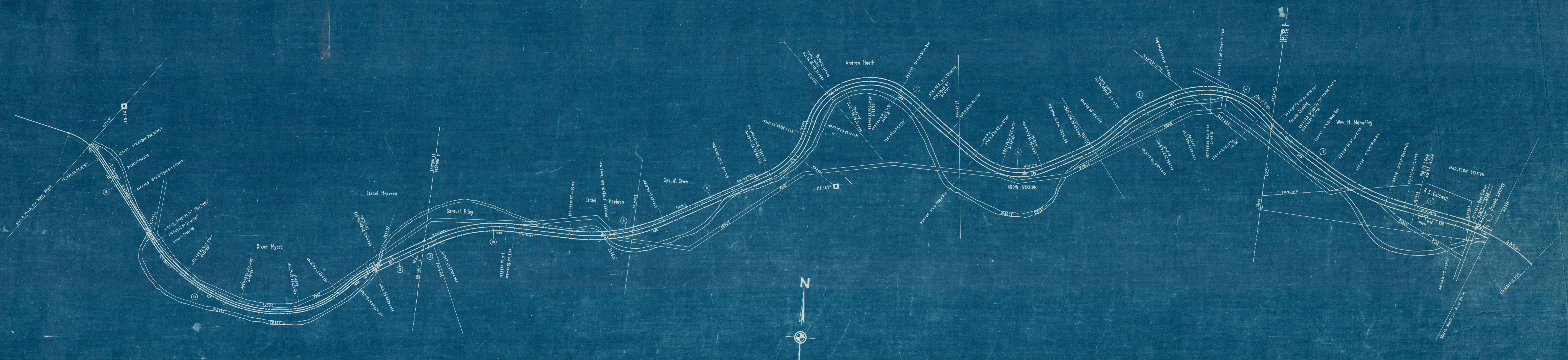

SCHEDULE OF SIDINGS AND CROSSOVERS

Side	Track	Location	Class	Length	Private	Total	Remarks
1	2	3	4	5	6	7	8
							Removed 5-30-36

Correct as of Dec. 31st, 1935- No Revision	Correct as of Dec. 31st, 1942- No Revision	Correct as of Dec. 31st, 1923- No Revision
Correct as of Dec. 31st, 1934- No Revision	Correct as of Dec. 31st, 1941- No Revision	Correct as of Dec. 31st, 1928- No Revision
Correct as of Dec. 31st, 1933- No Revision	Correct as of Dec. 31st, 1940- No Revision	Correct as of Dec. 31st, 1927- No Revision
Correct as of Dec. 31st, 1932- No Revision	Correct as of Dec. 31st, 1939- No Revision	Correct as of June 30th, 1927- No Revision
Correct as of Dec. 31st, 1931- No Revision	Correct as of Dec. 31st, 1938- No Revision	Correct as of June 30th, 1926- Map Revised
Correct as of Dec. 31st, 1930- No Revision	Correct as of Dec. 31st, 1937- No Revision	Correct as of June 30th, 1925- No Revision
Correct as of Dec. 31st, 1929- No Revision	Correct as of Dec. 31st, 1936- No Revision	Correct as of June 30th, 1924- No Revision
Correct as of Dec. 31st, 1928- No Revision	Correct as of Dec. 31st, 1935- Map Revised	Correct as of June 30th, 1923- No Revision
Correct as of Dec. 31st, 1927- No Revision	Correct as of Dec. 31st, 1934- No Revision	Correct as of June 30th, 1922- No Revision
Correct as of Dec. 31st, 1926- No Revision	Correct as of Dec. 31st, 1933- No Revision	Correct as of June 30th, 1921- No Revision
Correct as of Dec. 31st, 1925- No Revision	Correct as of Dec. 31st, 1932- No Revision	Correct as of June 30th, 1920- Map Revised
Correct as of Dec. 31st, 1924- No Revision	Correct as of Dec. 31st, 1931- Map Revised	Correct as of June 30th, 1919- Map Revised
Correct as of Dec. 31st, 1923- No Revision	Correct as of Dec. 31st, 1930- No Revision	Correct as of June 30th, 1918- No Revision

Sheet M411811 of Ohio River and Western Railway
from survey station 118+00 to survey station 411+45.
Chief Draftsman.

WESTERN RAILWAY
RIGHT OF WAY AND TRACK MAP
OHIO RIVER AND WESTERN RAILWAY
STATION 316+80 TO STATION 411+45
SCALE: 1 INCH = 200 FEET JUNE 30, 1917
OFFICE OF VALUATION ENGINEER
PITTSBURGH, PA.

FORMERLY
V. 24 OHIO 3.3
V. 12 OHIO 3.3
V. 1 OHIO 4
V. 3 OHIO 4

Portion of O. & W. Ry. Abandoned April 15, 1916, from Selaw, Ohio, Engineering Sta. 6100 to Woodlawn, Ohio, Engineering Sta. 2220+00. Trackage 1.562 mi. No. 8477. Dated Mar. 3, 1917. Pt. 32-1170.
Portion of O. & W. Ry. Purchased by the P.O.V. & C.R.R. April 15, 1917, from Selaw, Ohio, Engineering Sta. 0+00 to Crow, Ohio, Engineering Sta. 603+82. Finance Docket No. 8416. Dated Mar. 3, 1917. Pt. 32-1170-01-1172.

PARCEL No.	GRANTOR	GRANTEE	KIND OF INSTRUMENT	DATE OF INSTRUMENT	RECORDED			CUSTODIAN'S RECORD			AREA	REMARKS		
					BOOK	PAGE	DATE	R. E. A.'s No.	BOX	PKG.				
1														
2	R.E. Caldwell	B. & S.W. Ry. Co.	Release	Sep. 29, 1876				A-279084				0.85A.	Listed Map 3, Parcel 20. Grantor to fence.	
3	Wm. H. Mehaffey	B. & S.W. Ry. Co.	"	May 10, 1877				A-279085				0.79A.	Right of way for new road in lieu of old road used for track.	
4	No papers found											0.57A.		
5	No papers found											0.82 A.		
6	No papers found											1.08A.		
7	Andrew Heath	B. & S.W. Ry. Co.	Release	Apr. 21, 1876				A-279086				1.13A.		
8	Geo. W. Crow	"	"	"				A-279087				1.84 A.		
9	Isreal Hepbron	"	"	"				A-279088				0.21A.	Instrument includes Pcl. 12.	
10	Samuel Riley	"	"	May 3, 1876				A-279089				1.28A.		
11	Wm. Hathorn	"	"	Feb. 27, 1877				A-279174				0.07A.		
	do.	"	"	About 1876										
12	Isreal Hepbron	"	"	Apr. 21, 1876				A-279088				0.36A.		
13	Dixon Myers	"	"	Apr. 21, 1876				A-279090				0.99A.		
14	No papers found											0.67A.		
15	O.R. & W. Ry.	P.O.V. & C.R.R.	Q.C. Deed	Apr. 15, 1931	286	430		38897	2871	1			Includes Parcels 1 to 14. Sale covers Sta. 0+00 to Sta. 603+82.	

~~V.S. 1. Ohio~~